

MAINTENANCE

VALVE INSTALLED ON THE TANK

1. Check the tank pressure is lower than the service pressure.
2. Go to the area where the valve is installed.
3. Check no leak exists between the poppet seal and the seat, this check can be done with leakage detection fluid. If a leak exists, follow next points to dismantle the relief valve for further maintenance.

REMOVE THE VALVE FROM THE TANK

This operation is done to change the valve for further check

1. Before any operation, check there is no pressure in the tank.
2. Unscrew the screws that hold the MEGA-SUPERVENTIX to the tank pad, remove the valve and the disc.
3. Plug the hole in the flange with a blind cap to protect the tank from dust.

Further valve disassembly should be done in a workshop.

RELIEF VALVE DISASSEMBLY

We recommend this operation every two years.

CAUTION: the springs load is between 100 daN en 400 daN, when cap is removed the springs can violently be ejected.

We recommend to safely disassemble the cap and slowly relief the spring set load.

1. Remove carefully the cap (11) considering the above caution.
2. Remove springs set (3) and pressure plate (6).
3. Remove pressure and vacuum seals (7) & (8)
4. Install a set of new seals
5. Reassemble the valve.

SET PRESSURE RIGGING

The valve is installed on a test rig. The pressure is measured with a manometer precision class 0,5. The leakage is detected with leak test fluid at pressure seal interface.

1. Slowly increase the pressure. **When first bubbles appear at pressure plate seal, note the pressure.**
 2. Adjust the cap (screw/unscrew) to get the set pressure.
- If set pressure can not be achieved easily, we recommend to change the spring set (3) (see page 3 for item references). Only PEROLO provided spring sets should be installed
3. When setting complete, seal the cap with a stainless steel wire spot welded between cap and body.

The relief valve is ready to operate on the tank.

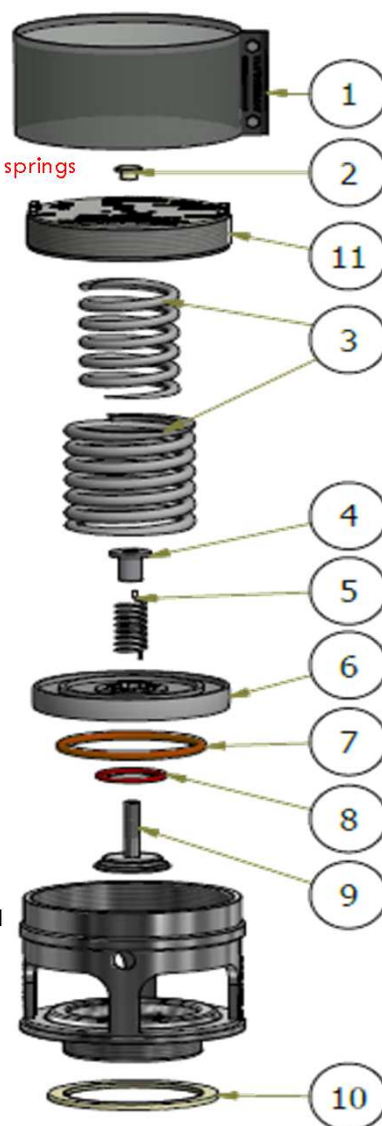

BODY MARKING (For MX65F & MP65F)



- 1) Setting Pressure (Bar)
- 2) Setting Pressure (Psi)
- 3) Full Flow (SCFM)
- 4) Full Flow (Sm³/S)
- 5) Full Flow Pressure (Psi)
- 6) Full Flow Pressure (Bar)
- 7) Certified Flow 90% (SCFM)
- 8) Certified Flow 90% (Psi)
- 9) Vacuum (Bar)
- 10) Vacuum ("Hg)
- 11) Serial number
- 12) P/N (MX65F or MP65F)
- 13) Nominal diameter (ND65)
- 14) Pressure tolerance (Bar)
- 15) Flow section (mm²)
- 16) Standard : ISO 41 26-1
- 17) "G" indication for gaz



PED ADDITIONNAL BODY MARKING (For MP65F Only)

Body marking is only made on PED approved safety relief valve (when reference starts with MP)

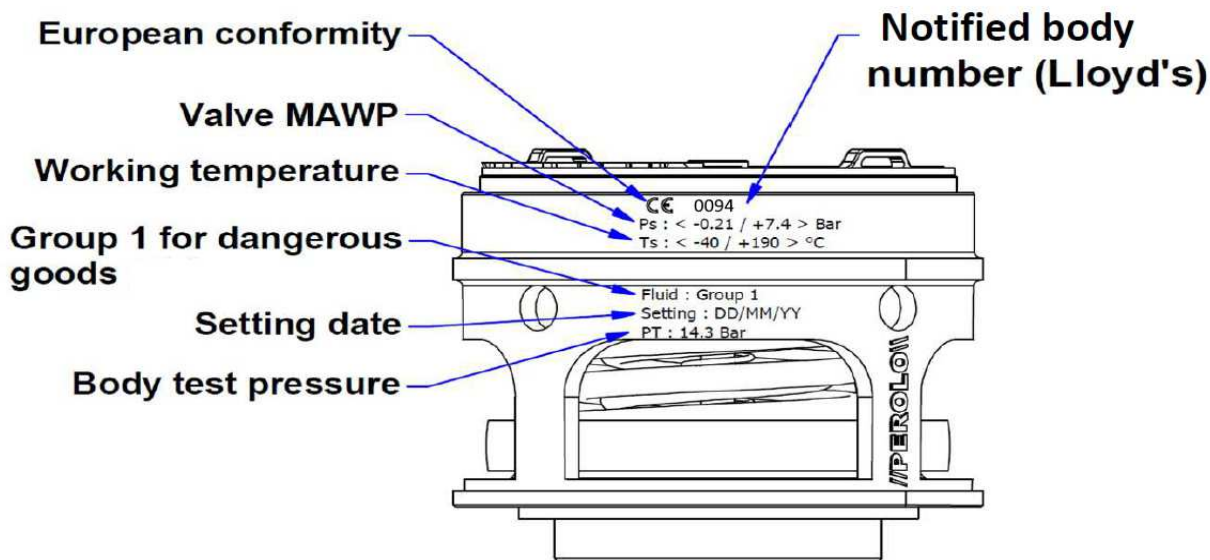

2 1/2" (ND65) SAFETY RELIEF VALVE

BSP MEGA SUPERVENTIX MX65F & MP65F(PED)

ITEM	QTY	DESIGNATION	PART N°
Pressure & Vacuum O'ring:			
7	1	Pressure O'ring (FEP/Silicone)	11 10 01 99 05
7	10	Pressure O'ring (FEP/Silicone)	11 10 01 99 06
7, 8	1	Pres. & Vac. O'ring (FEP/St)	11 10 01 91 00
8	10	Vacuum O'ring (FEP/Silicone)	11 10 17 99 00
Spring sets:			
3	1	Spring set pressure 2.18 Bar	11 10 01 95 00
3	1	Spring set pressure 3.30 Bar	12 12 84 90 00
3	1	Spring set pressure 3.75 Bar	11 10 01 96 00
3	1	Spring set pressure 4.40 Bar	11 10 01 97 00
5	1	Spring set vacuum 0.21 bar	11 10 01 98 00
Plates, Gauze & Cap:			
6	1	Pressure plate for pressure only	11 10 01 99 01
6	1	Pressure plate, pressure/vacuum	11 10 01 99 00
9	1	Vacuum poppet	11 10 01 99 02
2, 4, 5, 6, 7, 8, 9	1	Vacuum set kit (plug, adjustment nut, pressure plate, o'rings, spring set and vacuum poppet)	11 10 01 99 08
4	1	Adjustment nut	11 10 02 99 06
1	1	Flame proof gauze kit	11 10 01 50 91
1	10	Flame proof gauze kit	11 10 01 50 95
2	1	Plug (LDPE)	70 14 06 90 15
Setting gasket:			
10	1	Gasket Comp/PTFE	12 91 31 91 01
10	10	Gasket Comp/PTFE	11 10 01 92 00
10	1	Gasket Perbun./PTFE	11 10 01 93 00

DESIGNATION	SPECIFICATIONS	PART N°
Weld-in flange	Ext Ø 127mm, int Ø 76mm thickness 25 mm, 316L st st drilling 6 x M10 x 105 PCD	12 91 14 00 00
Recess flange	Ext Ø 166mm, int Ø 76mm min thick. 22 mm max th. 61 mm drilling 6 x M10 x 105 PCD 316L stainless steel	12 92 14 00 00
Adaptator Flange for Bursting Disc Assembly	Ext Ø 127mm, int Ø 2" BSP thickness 22.5 mm, 316L st st drilling 6 x 11 x 105 PCD 1/4" BSP gauge connection	11 91 15 00 00 + 11 91 15 00 01 (without gauge protection)
Bursting disc	4.84 Bar	DRS65P484T20
Gauge (0-6 bar) bottom entry 1/4"BSP	Full stainless steel	70 18 06 00 95
	Stainless steel case	70 21 02 00 22

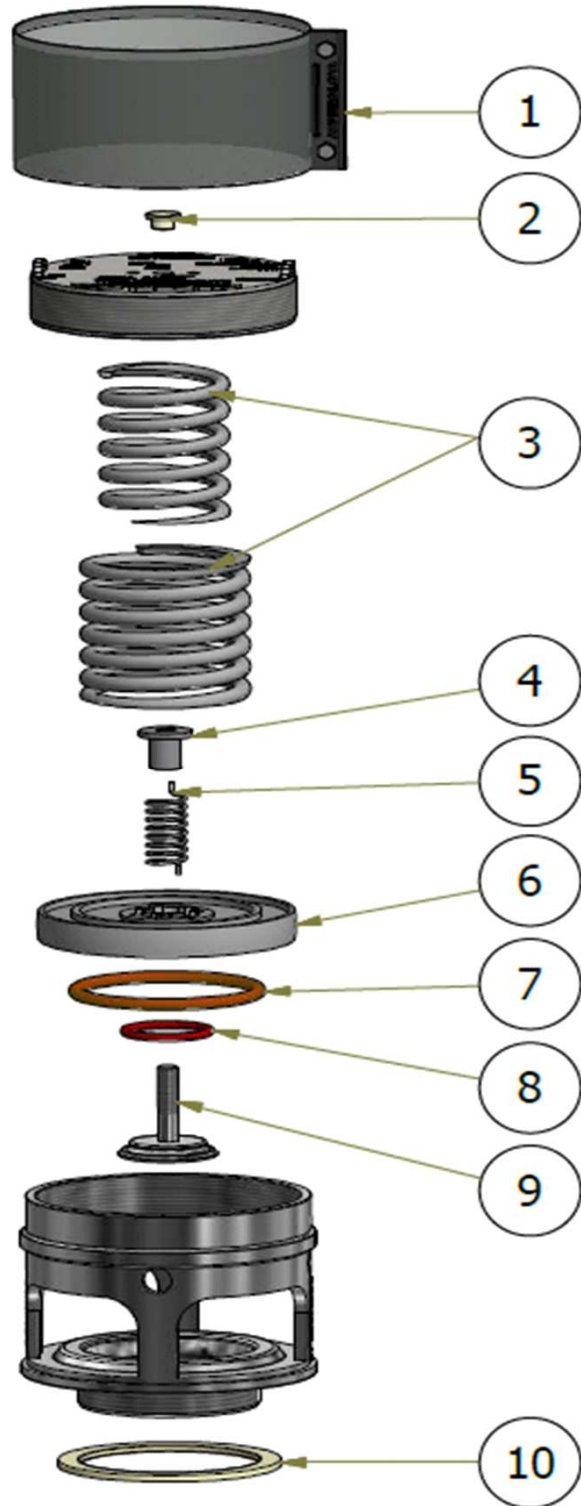

SAFETY RELIEF VALVE