

## INSTALLATION

To use the ND80 ATCO™ full bore as an air inlet/outlet:

1. Ensure that the Inlet (tank side) flange is clean; free from dirt and grit.
2. Screw the studs into the weld in flange.
3. Place the gasket and siphon tube if any
4. Fit ball valve on the weld in flange and secure with washers and nuts.

The required tightening torque is 70 N.m +/-5

5. Assemble gasket and blind flange on the top and secure using bolting kit.

Refer to our PWAGEN001 sheet for flange tightening details

To be opened/closed by hand only

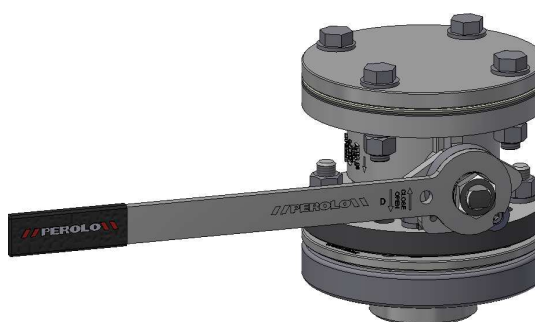
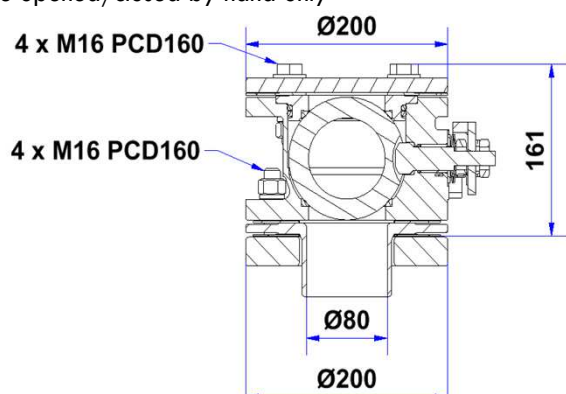

ITEM	DESCRIPTION	SPECIFICATION	PART N°
8	Bolting Kit	4 x M16-65 Screw 4 x M16 nuts and 4 x grower washers and 4 washers	19 11 08 90 02
7	Bolting Kit	4 x M16-64 studs 4 x M16 nuts and 4 x grower washers	11 17 07 95 00
6	Blind flange	ext Ø 200mm, thickness 13.5mm 4x18,5x160PCD, 316L stainless steel	11 95 90 00 00
5	Gasket	ext Ø 200mm, int Ø 81mm - CNAF/PTFE 8xØ18x160PCD and 6xØ14x168PCD	17 11 23 00 00
4	ND 80 ATCO	PN 16 Full Bore, 316 L stainless steel Inlet flange 8xØ17x160PCD Outlet flange 8xØ18x160PCD	AFN8X16T22S00 0
3	Syphon Tube	ext Ø 200mm, int tube Ø 80mm ext tube guide Ø 93mm, thickness 8mm 6x14xPCD168 & 4x18xPCD160 - 316L	12 92 18 10 00
2	Gasket	ext Ø 185mm, int Ø 94mm 4xØ18x 160PCD, CNAF/PTFE	12 91 40 00 00
1	Weld-in flange	ext Ø 200mm, int Ø 94mm thickness 26.5 mm 6xM12xPCD168 & 4xM16xPCD160 316L stainless steel	11 90 36 00 00

ASSEMBLY EXAMPLE  
WITH SYPHON TUBE

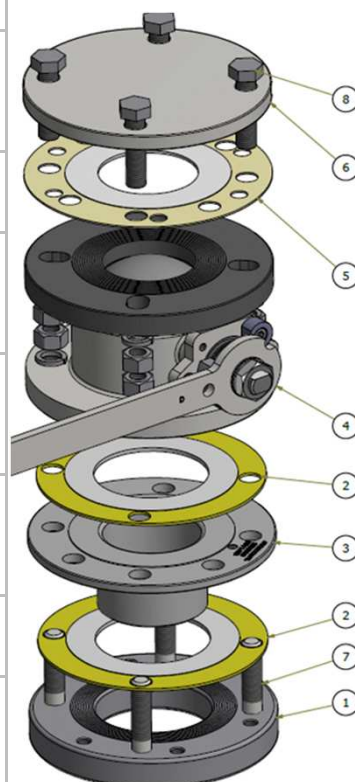

**if a piping system linked to the tank is installed on the process side of the valve, we recommend to have a flexible hose in-between the valve and the piping system to avoid any additional stress on the fastening studs**

Due to our policy of continuous product improvement, specifications may change without notice - Installation sheet PWA 11 12 71 30 00 F  
It is the customer's responsibility to check the compatibility between valves material and transported product.



